





















— SITE BOUNDARY TO APPLICATION SITE - 22.4ha  
— SITE BOUNDARY TO LAND IN THE OWNERSHIP OF THE FOOTBALL ASSOCIATION

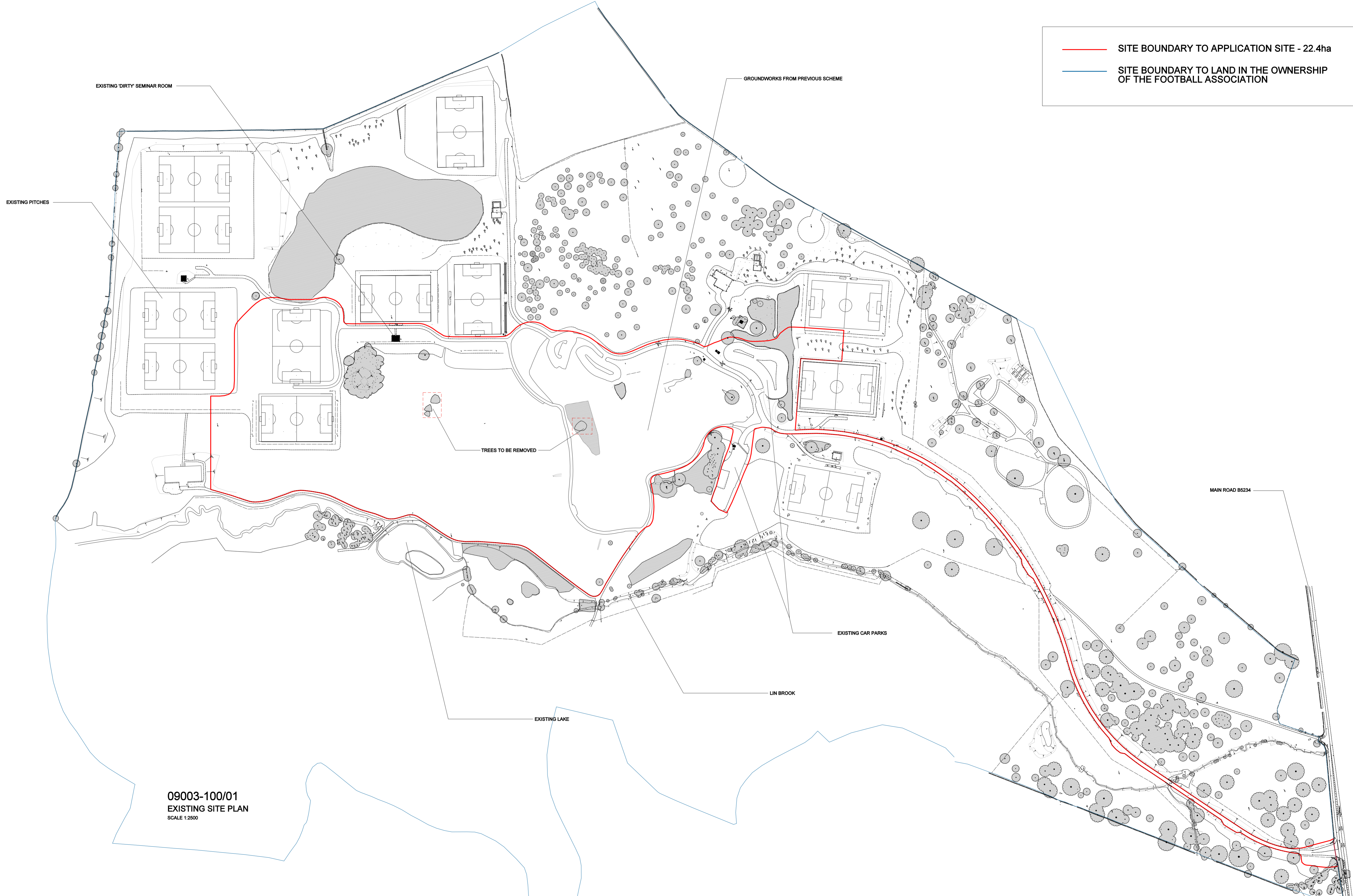

**redboxarchitecture**  
 Red Box Architecture, St Nicholas Church, Newcastle upon Tyne, NE1 1RJ  
 t: +44 (0)191 245 7105, f: +44 (0)191 245 7111, mail@redboxdesign.com, www.redboxdesign.com  
 Red Box Design Group Ltd trading as Red Box Architecture  
 redboxdesigngroup : redboxinteriors : redboxgallery  
 copyright © Red Box Design Group Ltd 2010

**THE NATIONAL FOOTBALL CENTRE**  
**ST. GEORGE'S PARK**  
**EXISTING SITE PLAN**  
 1:2500  
 A1 09 003 PLANNING 100 B

B	ISSUED FOR PLANNING	2010.02.12	SG	BF
A	Red Line Boundary Issue	2010.02.04	MC	BF
	Draft Issue For Comments	2010.01.29	MC	SG
Rev	Notes	Date	By	Review

**NB: FOR SITE LOCATION RELATIVE TO BURTON SEE CONTEXT PLAN FROM NLP (DRAWING NUMBER MA 40509/001)**  
**FOR LARGER SCALE EXISTING SITE PLAN SEE RBA DRAWING 101.**

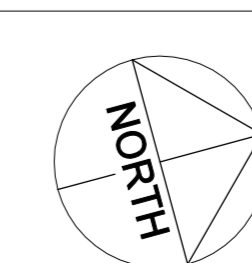

Notes  
 1. To be read with CDM Risk Register  
 2. Do not scale, check this is the latest version, if in doubt, ask see drawing issue log for issue history